



Basic socket series designation for:

Series X

Designed to the standards and requirements of:

MIL-DTL-12883/45

SOCKET DRAWING

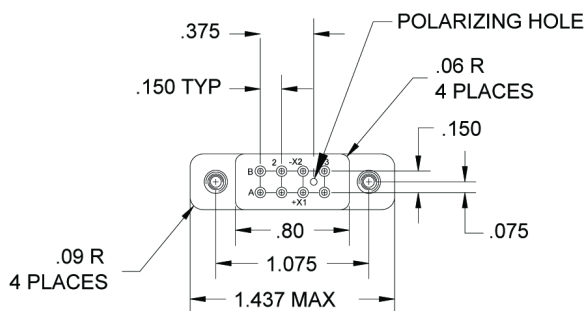

HARDWARE MOUNTING

MOUNTING DETAIL 2 PLACES

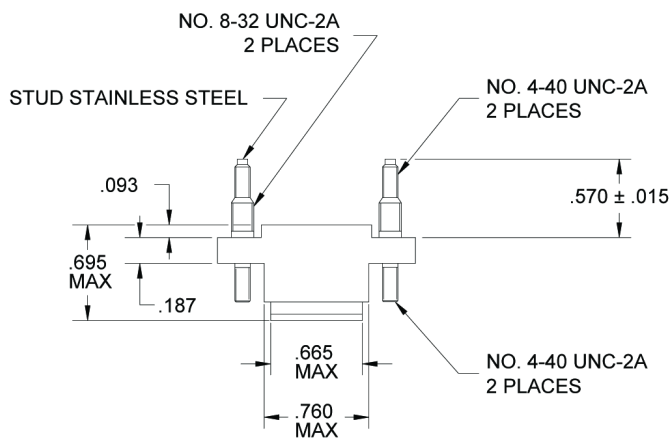
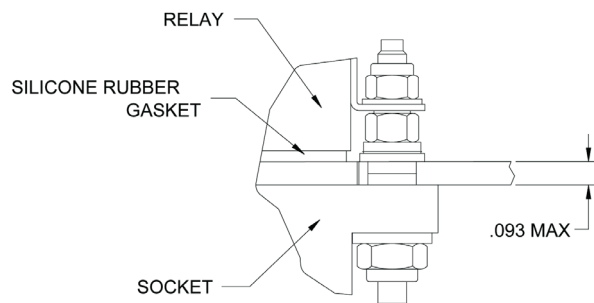

MOUNTING DIMENSIONS

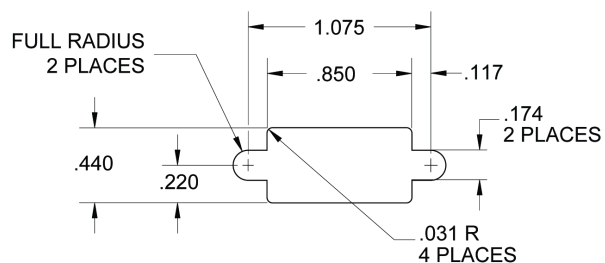

GENERAL CHARACTERISTICS

1. Supplied with mounting hardware and No. 20 contacts and No. 20 crimp.	
2. Standard tolerances	.xx ± .01; xxx ± .005
3. Weight	.030 lbs. max
4. Temperature range	-65° C to +125° C